

# Remote seller's packaged liquor licence

This kit contains all the forms and related materials required to apply for a remote seller's packaged liquor licence in Victoria.

**Contents:**

1. Useful information and definitions
2. Lodgement checklist
3. Application form – remote seller's packaged liquor licence
4. Right to occupy the premises declaration
5. Questionnaire
6. Declaration of associates
7. Public notice (this must be displayed as A3 size)
8. Statement of display
9. Guidelines for displaying public notices
10. Companion guides:
  - 'Plans of licensed premises' fact sheet
  - 'Training for licence applicants' fact sheet

Visit [vic.gov.au/liquor-licence-application-fees](https://vic.gov.au/liquor-licence-application-fees) to confirm the licence application fee.

## How to apply

This is an interactive PDF form which allows you to:

- complete the form using a computer or tablet
- save your progress and continue at a later time
- print the completed form to sign and return.

You are still able to print the form and complete it by hand if you prefer.

This form has been designed to be completed using the free Adobe Acrobat Reader software. To download this free software, [please visit the following link](#) or search for the free "Adobe Acrobat Reader" on your device's app store.

**This form may not function as intended if you use any other software.**

**Send application to:**

Liquor Control Victoria  
PO Box 1019  
Richmond VIC 3121

**or via email to:**

[contact@liquor.vic.gov.au](mailto:contact@liquor.vic.gov.au)

## Need help?

For more information on how to apply for a liquor licence or permit:

- visit Liquor Control Victoria (LCV) website at [liquor.vic.gov.au](https://liquor.vic.gov.au)
- telephone LCV on 1300 182 457
- email LCV at [contact@liquor.vic.gov.au](mailto:contact@liquor.vic.gov.au)

## Privacy

Liquor Control Victoria (LCV) is committed to protecting the privacy of your personal information. LCV endorses fair information handling practices and uses of information in compliance with its obligations under the *Privacy and Data Protection Act 2014* (Vic). Personal information collected from you is only used for the purposes of the application for the licence or permit and Acts administered by LCV.

Personal information is not disclosed to third parties unless required or authorised by law, or with your consent. As part of the application process information provided may be forwarded to and retained by Victoria Police.

# Remote seller's packaged liquor licence

## Remote seller's packaged liquor licence

This licence allows the licensee to supply liquor ordered by off-premises request in sealed containers, bottles or cans on the licensed premises for consumption off the licensed premises.

### Off-premises request

Off-premises request means a request for the supply of liquor by mail, telephone, facsimile, internet or other electronic communication, by a person who is not on the licensed premises at the time the request is made.

### Application fee

The application fee must be paid at the time of application. If your application is granted, the renewal fee for the following year is due annually on 31 December, irrespective of when the licence is granted. A renewal notice will be issued prior to this date detailing how to make payment. There is no GST payable on this fee. Please refer to the liquor licence fees fact sheet for current details. The fee can be paid by cheque, money order or credit card. Cheques and money orders are to be made payable to Liquor Control Victoria.

### Declaration of the right to occupy the premises

For a licence to be issued, the applicant must have the right to occupy the premises. You will need to provide a declaration of your right to occupy the premises once the lease agreement has been executed and/or settlement has occurred for the sale of the property and/or you have otherwise acquired the legal right to occupy the premises (i.e. you are the freehold owner of the premises, the Certificate of Title is in your name or your name is on the executed lease agreement, etc).

If you do not have the right to occupy when you lodge your application, you will need to provide a declaration once you have acquired the right to occupy the premises. Please send or email LCV your declaration..

### Declaration of associates

The purpose of the declaration of associates form is to identify an applicant's associates. The application must be accompanied by completed declaration of associates form(s).

- If the applicant is an individual, the individual must complete the form.
- If the applicant is a partnership, each partner must complete the form separately.
- If the applicant is a body corporate, the body corporate must complete the form advising of its associates and each director of the body corporate must complete this form separately

### Incorporated association information

If you are applying for a licence in the name of an incorporated association you must provide the certificate of incorporation, rules and minutes of the most recent meeting confirming the committee members.

### Current and Historical Company Extract – company applicants only

If you are applying for a licence in the name of a company you are required to provide a recent (no more than 90 days old) Current and Historical Company Extract from the Australian Security and Investments Commission (ASIC). Current and Historical Company Extract identifies the type, status, registered address, roles within the organisation, share structure, members and charges and documents lodged (current and historical) of organisations registered with ASIC.

When making a search application to ASIC, ensure that you specify that you require a Current and Historical Company Extract and not a Current Company Extract. A Current and Historical Company Extract identifies both current and historical information about the applicant, while the Current Extract identifies only current information.

You can purchase a Current and Historical Company Extract from the ASIC website at [asic.gov.au](https://asic.gov.au)

### Incorporated association information

If you are applying for a licence in the name of an incorporated association you must provide the certificate of incorporation, rules and minutes of the most recent meeting confirming the committee members.

### Display of application

A public notice must be displayed at the premises to which this application relates. Once your application has been accepted for processing, LCV will notify you or your representative in writing of the period the public notice must be displayed.

**Important: You must NOT display your public notice until LCV has advised you to do so.**

After the display of notice has ended, you must then lodge a 'Statement of display' to LCV certifying that you have undertaken a public notice of display. Please refer to the enclosed 'Guidelines for displaying public notices' and 'Statement of display'.

# Remote seller's packaged liquor licence

## Planning permission

Please provide a copy of a planning permit from the local council (or responsible planning authority) which shows that you have planning permission to supply liquor as outlined in your application. For example, this should show that you have planning permission for the activities permitted by the licence type, the trading hours you are applying for and the area where you would like to supply liquor (red-line area). If a planning permit has not been granted at the time of your application, you are required to provide a copy of an application for a planning permit made to the local council (or responsible planning authority).

Alternatively, you can provide evidence that a planning permit is not required to supply liquor as outlined in your application. For example, a letter from the local council (or responsible planning authority) or a copy of the relevant planning scheme.

## Red-line plan

Remote seller's packaged liquor licences are granted for a specific area or areas where the orders for liquor are picked and packed for delivery. This area is called the licensed premises. For example, the licensed premises may be a warehouse or part of a warehouse set aside for your use for picking and packing. The licensed area is marked by a red line drawn on a plan of the premises outlining the area for your use. The red-line plan must be provided to LCV with your application.

For **shared premises**, only the area set aside for you to pick and pack orders should be red lined. Shared areas where liquor is stored but not picked and packed, or where orders are placed for pick-up for takeaway or delivery, should not be included in the redline plan.

If you have **more than one premises** where orders are picked and packed, you must provide a red-line plan for each premises.

## Body corporate definition

A body corporate is an organisation which has a separate legal status to its members (i.e. it can own property, sue and be sued, and enter into contracts in its own name). Examples of body corporates include companies, incorporated associations, incorporated partnerships, municipal councils and co-operatives. Unincorporated clubs/associations and unincorporated partnerships are not body corporates. A minimum of one director must reside in Victoria unless a proposed nominee has been nominated.

## Nominee definition

A body corporate may apply to the LCV for the approval of a person to be the nominee of the applicant. Once approved, the nominee then becomes liable as if they were the licensee or permit holder. The nominee will cease being a nominee if they cease to manage or control the licensed premises. Where this occurs, the licensee or permit holder needs to notify LCV within 14 days. The nominee must reside in Victoria.

## Alcohol management strategy

An alcohol management strategy is a document which explains the actions you will take to reduce the harm associated with the supply of liquor from your packaged liquor outlet. If you intend to offer rapid delivery, which is delivery within two hours of the order being made, or do promotions, you must have an alcohol management strategy and give us a copy with your application.

If you intend to offer **rapid delivery**, your alcohol management strategy should include information in response to (but not limited to) the following:

- what kind of training and support will be given to your staff about your obligations around delivery of liquor
- will you manage the risk of harm in any other way, for example, will you limit the amount of liquor that can be ordered at a time, or the times that liquor can be ordered for rapid delivery
- provide details of how you will make sure that only a person over the age of 18 receives a delivery
- provide details of how you will manage an intoxicated or drunk person trying to receive a delivery
- how will you make sure that a delivery is received by a person, and not dropped off unattended.

If you intend to do **promotions**, your alcohol management strategy should include information in response to (but not limited to) the following:

- what kind of discounting or liquor promotions do you intend to do, for example, will you do two-for-one promotions, discounts for bulk buying or offer gifts of bonus alcohol with purchases
- how will you manage the risks associated with discounting or doing liquor promotions.

## Lodgement checklist

# Remote seller's packaged liquor licence

This checklist details the documents required to accompany your application. Supplying these with your application will allow Liquor Control Victoria (LCV) to commence assessment of the application and can reduce processing time. Your application may be returned if the accompanying documents do not meet the requirements below. LCV may contact applicants to request additional documentation depending on the circumstances of their business. All forms and fact sheets referred to are available on LCV's website [liquor.vic.gov.au](http://liquor.vic.gov.au)

### Please tick that you have provided all the required documents with lodgement of your application

#### Application form

Please ensure:

- all fields on the application form are completed
- the nature of the business is detailed, clearly demonstrating why a liquor licence is sought
- application form is signed and dated by the applicant
- that correct fees are attached, as detailed in the 'Liquor licence fees' fact sheet.

#### Planning permit OR evidence that a permit is not required

A copy of the planning permit from the local council (or responsible planning authority) showing that you have planning permission to supply liquor as detailed in your application OR a copy of an application for a planning permit made to the local council (or responsible planning authority).

Alternatively, you can provide evidence that a planning permit is not required to supply liquor as outlined in your application. For example, a letter from the local council (or responsible planning authority) or a copy of the relevant planning scheme.

#### New entrant training

A copy of an approved new entrant training certificate for all required persons is needed in order to determine the application, as detailed in the 'Training for licence applicants' fact sheet.

#### Declaration of the right to occupy the premises

For a licence to be issued, the applicant must have the right to occupy the premises. If you already have the right to occupy the premises, you must sign and attach the declaration provided at the end of this form.

#### Questionnaire

Each person listed on the application, including any nominee, must complete a 'Questionnaire' attached in this application kit. For companies, partnerships or clubs, questionnaires are required from each director, partner or executive committee member respectively. Questionnaires will only be accepted if they are dated within the last three months.

#### Declaration of Associates

The declaration of associates form attached within this application kit must be completed by each of the following:

- If the applicant is an individual, the individual must complete the form.

- If the applicant is a partnership, each partner must complete the form separately.
- If the applicant is a body corporate, the body corporate must complete the form advising of its associates and each director of the body corporate must complete this form separately.

#### A copy of the red-line plan or plans

You must provide us with a plan of your premises, with the proposed area where liquor orders will be picked and packed drawn with a red line around the area. If you have more than one premises, we require a red-line plan for each premises. Please see the 'Plans for licensed premises' fact sheet in this kit for more information on red-line plans.

#### Business name certificate (if applicable)

A business name certificate is required if an individual or partnership is applying for a liquor licence, or if the trading name of the business registered with Australian Securities and Investment Commission (ASIC) is different to the company's name or incorporated club's name. A copy of the business name certificate from ASIC is required. To register your business name, go to the ASIC website at [asic.gov.au](http://asic.gov.au) for further information.

#### Current and Historical Company Extract

A recent (no more than 90 days old) Current and Historical Company Extract is required if a company is applying for a liquor licence. A Current and Historical Company Extract can be purchased from the ASIC website at [asic.gov.au](http://asic.gov.au)

Refer to the 'Useful information' section for further information.

#### Incorporated association information

If you are applying for a licence in the name of an incorporated association you must provide the certificate of incorporation, rules and minutes of the most recent meeting confirming the committee members.

#### Alcohol management strategy (if applicable)

You only need to give us an alcohol management strategy if you intend to do rapid delivery, promotions, or both.

## How to lodge this form

#### By post

Liquor Control Victoria  
PO Box 1019, Richmond VIC 3121  
Phone: 1300 182 457

#### By email

[contact@liquor.vic.gov.au](mailto:contact@liquor.vic.gov.au)

## What happens next

If your application is accepted, you will be emailed or sent an acknowledgement letter. This will confirm that LCV has received your application and outline any further information required and the date by which it must be submitted. Once LCV has received all required information and documents, your application will be determined. You will be advised of the outcome in writing.

## Remote seller's packaged liquor licence

Liquor Control Reform Act 1998

## 1. Details of premises

Trading name of premises to be licensed\*  
(as stated on your certificate of registered business name)

\* Please tick that you have attached a copy of your business name certificate from ASIC as it is required to finalise processing of your application (see lodgement checklist for further information)

Street address of premises to be licensed (if you have more than one premises, use your main premises here)

Postal address of premises to be licensed  
(for service of documents if different from street address)

Premises email

Correspondence may be sent by email. Please mark the box if you DO NOT wish to receive correspondence by email.

Owner (landlord) of premises to be licensed (if you have more than one remises, use your main premises here)

Owner's (landlord) postal address (for service of documents if required)

## 2. Applicant details

Type of applicant (tick one box)

Person Partnership Company Club

Name(s) of applicant (person/partnership/company/body corporate/club)

Australian Business Number (ABN)\*

Australian Company Number (ABN)\*\*

Contact name (business hours contact details)

Daytime telephone number (business hours contact details)

Email address

Mobile telephone number (business hours contact details)

Correspondence may be sent by email. Please mark the box if you DO NOT wish to receive correspondence by email.

Give details of each person, partner, director, or executive committee member who is part of this application (if more than six people, attach a separate page which lists all names and addresses).

Each individual listed below will need to complete a 'Questionnaire', which forms part of this application.

Full name	Residential address	Position held/Relationship to applicant (i.e. director etc.)

\*ABN is a unique identifier issued by the Australian Business Register which is operated by the Australian Tax Office.

\*\*ACN is a unique nine-digit number issued by the Australian Securities and Investments Commission to companies.

### 3. Nominee details – body corporate only (body corporate can be companies, incorporated associations, incorporated partnerships, municipal councils and co-operatives)

A body corporate may apply for approval of a person as nominee of the applicant. The nominee must complete a 'Questionnaire'.

Name of proposed nominee\*

Please refer to the 'Training for licence applicants' fact sheet to determine if the nominee requires new entrant and/or RSA training.

\* Once approved, the nominee then becomes liable as if he or she were the licensee or permit holder. Please refer to the Definitions section.

### 4. Authorised representative

The applicant can authorise a person or an organisation (such as a legal representative) to access and discuss details about this application.

Daytime telephone number

Do you want an authorised representative to make enquiries and provide information on your behalf regarding this application?

Mobile telephone number

NO

Postal address for service of documents

YES – please provide details below

Contact name

Organisation name

Email address

Correspondence may be sent by email. Please mark the box if you do not wish to receive correspondence by email.

### 5. Proposed person in day-to-day management or control of premises (body corporate only)

It is MANDATORY for body corporate applicants (company, incorporated association, a co-operative or a municipal council) to nominate the person in management or control of the premises who will run the day-to-day operations of the business.

Name of proposed person in management or control of premises

Daytime telephone number/mobile telephone number

The person who will be in management and control of the licensed premises must complete an LCV approved RSA training course and details of course completion must be provided in the 'Mandatory training' section.

### 6. Nature of the business

Provide details of the nature of the business you are intending to conduct and the purpose for which the liquor licence is sought.

Do you intend to offer rapid delivery? Rapid delivery is delivery within two hours of the order being made.

NO YES – please provide an alcohol management strategy (see Useful information and definitions section of this kit for instructions)

Does your business intend to sell discounted liquor (for example by selling dead or discontinued stock) or do you intend to do promotions that encourage bulk purchases?

NO YES – please provide an alcohol management strategy (see Useful information and definitions section of this kit for instructions)

## 7. Multiple licensed premises

Will orders be picked and packed from more than one premises?

YES – please provide details for each premises below and attach a copy of the red-line plan for each premises to your application  
NO

	Street address	Postal address (if different from street address)	Owner (landlord) of premises	Owner's (landlord) postal address
1.				
2.				
3.				
4.				
5.				

## 8. Trading hours

Ordinary trading hours are:

Sunday:	Between 10am and 11pm
ANZAC Day:	Between 12noon and 11pm
On any other day other than Good Friday and Christmas day:	Between 9am and 11pm

Please indicate the days and hours you propose to supply liquor. Please note that supply means when the order is picked and packed, not when it is shipped or delivered. Refer to the 'Liquor licence fees' fact sheet for details of fees applicable

## 9. Size of licensed premises

What is the size of the licensed premises?

## 10. Conditional approval

If the licence is granted, are you able to commence trading immediately?

YES

NO – provide details of likely date of commencement.



## 10. Mandatory training - new entrant training and Responsible Service Alcohol (RSA) training

Please refer to the 'Training for licence applicants' fact sheet to determine if you require new entrant and/or RSA training.

Have all required person(s) completed an LCV approved **new entrant training** course?

YES – please attach a copy of your certificate.

NO – a copy of your certificate must be attached or this application form may be returned.

Have all required person(s) completed an LCV approved **RSA training** course within the past three years?

YES – please provide details below.

NO – details of course completion must be provided below or this application form may be returned.

Full name	Position	RSA certificate number	Date of completion	Training provider

## 11. Right to occupy

For a licence to be issued, the applicant must have the right to occupy the premises. You need to provide a declaration of your right to occupy the premises once the lease agreement has been executed and/or settlement has occurred for the sale of the property and/or you otherwise acquired the legal right to occupy the premises.

Please tick that you have attached the 'Right to occupy the premises declaration' form with your application if you already have the right to occupy the premises to which this application relates.

If you do not have the right to occupy the premises to which this application relates, please provide the proposed date on which you expect to have the right to occupy the premises.

Please send or email LCV your declaration once you have the right to occupy the premises. LCV cannot finalise your application until this declaration has been received.

## Signature by applicant

This application must be signed by the applicant if the applicant is:

**A person –**  
That person

**A company –**  
One director of the company

**A partnership –**  
All partners

**A club –**  
One committee member

**I/ we declare/certify that:**

- the information contained in this application, including attachments is true and correct.
- if a body corporate applicant, I am authorised to sign this application on behalf of the body corporate.

Signature:

Date (dd/mm/yyyy):

Print name and position:

Signature:

Date (dd/mm/yyyy):

Print name and position:

Signature:

Date (dd/mm/yyyy):

Print name and position:

Signature:

Date (dd/mm/yyyy):

Print name and position:

It is an offence under section 118 of the *Liquor Control Reform Act 1998* to make a statement that is false or misleading in relation to this application. An offence under section 118 of the *Liquor Control Reform Act 1998* carries a maximum penalty of 60 penalty units.



## Payment method

### IMPORTANT INFORMATION

Applications must be accompanied by the relevant fee. Please note that once an application has been registered, the application fee is non-refundable. Visit [vic.gov.au/liquor-licence-application-fees](https://vic.gov.au/liquor-licence-application-fees) to confirm the licence application fee. The application fee can be paid by:

- cheque or money order, made payable to Liquor Control Victoria; or
- credit card (Visa or MasterCard)

If you wish to make payment by credit card, please lodge your completed application with LCV and we will contact you directly to arrange payment if your application is accepted.

Please select your payment method:

Money order

Cheque

**Privacy** – LCV is committed to responsible and fair handling of personal information consistent with the *Privacy and Data Protection Act 2014 (Vic)* and its obligations under the *Liquor Control Reform Act 1998*. Your credit card details will not be retained once your payment has been processed.

This page intentionally left blank

# Declaration – right to occupy

For a liquor licence to be issued, **the proposed licensee must have the right to occupy the premises**. A right to occupy the premises may arise from being a tenant under a lease agreement, as a freehold owner of the property, or through some other legal arrangement.

If you do not have the right to occupy the premises when you lodge your liquor licence application, you will need to sign and submit this declaration once you have acquired the right to occupy the premises. Please mail or email your declaration to Liquor Control Victoria (LCV).

## Section A: Right to occupy the premises

Address of premises where right to occupy is held:

Please provide details of how you have obtained the right to occupy the premises by completing the section below that applies to your situation.

### 1. Freehold owner of property

Name the certificate of title is held in (person(s)/company/club):

### 2. Tenants of premises

Name of the tenant on the lease (person(s)/company/club):

### 3. Legal right to occupy premises

Name on the agreement or other document providing legal right to occupy premises is held in (person(s)/company/club):

Please specify how you have acquired the legal right to occupy the premises:

Please proceed to Section B if you are a transfer applicant, if not proceed to Section C.

## Section B: Date of settlement (transfers only)

**Do not submit this form until settlement has occurred. LCV cannot accept your declaration until settlement has occurred.**

Please specify the date settlement occurred:

(dd/mm/yyyy)

## Section C: Applicant declaration

**Who must declare?**

**If the applicant or proposed licensee is:**

- **A person:** That person
- **A company:** One director of the company
- **A partnership:** One partner
- **A club:** One committee member

I/we declare that this statement is true and correct and that the person(s)/company/club listed under section A has the right to occupy the premises, and I/we are authorised to make and sign this declaration:

Name of person making this declaration:

Signature of person making this declaration: Date (dd/mm/yyyy):

Name of person making this declaration:

Signature of person making this declaration: Date (dd/mm/yyyy):

**It is an offence under section 118 of the *Liquor Control Reform Act 1998* to make a statement that is false or misleading in relation to this application.**

**Penalties may apply.**

# Questionnaire

The following information is required from each applicant for a liquor licence or permit. If the application is from a company, partnership or club, a questionnaire is required from each director, partner or executive committee member. If a nominee is to be appointed, then they are also required to provide the following information.

## Important information you must read and note before completing this form

The information supplied on this form to Liquor Control Victoria (LCV) will be disclosed to Victoria Police as part of your application under the *Liquor Control Reform Act 1998* (the Act). Victoria Police will use the information you supply to make an informed decision on whether to object to your application on the grounds that you or anyone named on this form are not suitable to be involved directly or indirectly in the sale of liquor.

### Please Note:

- Complete all sections of this form in **BLOCK CAPITALS ONLY**.
- If you require any help in completing this form, assistance can be obtained from a legal practitioner or liquor consultant.
- Failure to provide requested information (no matter how minor) may be detrimental to the outcome of your application.
- Having a criminal record in itself may not prevent you or a body corporate you are involved with from being successful with your application.
- It is a criminal offence under Section 118 of the Act to provide false or misleading statements.
- This form is to be completed and dated no more than three months prior to your application being submitted.

## Personal information

Surname:

First name:

Middle name(s):

Date of Birth (dd/mm/yyyy):

Gender: Man Woman

Self-described:

## Residential address

## Contact details

Daytime telephone number Mobile telephone number

Business telephone number

Email address

Drivers licence number

(If you do not hold a drivers licence, please provide details of another form of photo identification)

State of issue

## Business address

## Business details

Name of business

Details of any other person who will, or is likely to directly or indirectly have a management role or exercise control over the business.

Surname:

First name:

Middle name(s):

Date of Birth (dd/mm/yyyy):

Gender: Man Woman

Self-described:

*continued over the page*

## Business details *continued*

Surname:

First name:

Date of Birth (dd/mm/yyyy):

Gender: Man Woman

If you require further space, please photocopy this section and attach it to the questionnaire.

## Criminal and other proceedings history

Have you ever been convicted of any offence in Australia or overseas? *(not including traffic offences)*

NO YES *provide details in the history detail section*

Have you been found guilty of any offence in Australia or overseas? (includes findings without conviction and good behaviour bonds) *(not including traffic offences)*

NO YES *provide details in the history detail section*

Have you ever been the subject of a diversion order?

NO YES *provide details in the history detail section*

Do you have any charges pending against you? *(not including traffic offences)*

NO YES *provide details in the history detail section*

Have you ever been charged with drink driving or driving whilst disqualified?

NO YES *provide details in the history detail section*

Has the Commission (or prior to 6 February 2012, the Director of Liquor Licensing or VCAT) previously made a finding that you were unsuitable under the Act?

NO YES *provide details in the history detail section*

Have police previously objected to your suitability in an application under the Act?

NO YES *provide details in the history detail section*

Have you, or have you been a director or a nominee of a body corporate and been found guilty of an offence under the Act?

NO YES *provide details in the history detail section*

Have you, as an individual received an infringement notice, or been a director or nominee of a body corporate that has received an infringement notice under the Act?

NO YES *provide details in the history detail section*

Have you been a director, nominee of a licensee, or a person who was concerned in or who took part in the management of licensed premises, that was the subject of a disciplinary action under the *Victorian Gambling and Casino Control Commission Act 2011* or the *Liquor Control Reform Act 1998*?

NO YES *provide details in the history detail section*

Has a licensed venue where you have been a director, nominee or licensee incurred liquor licence demerit points?

NO YES *provide details in the history detail section*

## History details

If you have answered yes to any of the questions under the criminal and other proceedings history section, please provide full details below:

Date (dd/mm/yyyy):

Court:

Offence:

Result:

Date (dd/mm/yyyy):

Court:

Offence:

Result:

If you require further space, please photocopy this section and attach it to the questionnaire.

## Personal bankruptcy

Are you currently insolvent or under administration?

NO YES *provide full details*

Have you ever been declared bankrupt? *provide full details*

NO YES *provide full details*

**Please ensure this form is completed in full, as incomplete, or partially completed forms may require you to submit a further questionnaire and will delay your application.**

## Signature of applicant

I acknowledge that this declaration is true and correct and is made in the belief that a person making a false declaration is liable to prosecution for making a misleading statement.

Signature of applicant:

Date (dd/mm/yyyy):

Name of applicant:

# Declaration of associates

Liquor Control Reform Act 1998

## Directions for completing the form

This is an interactive PDF form which allows you to:

- complete the form using a computer or tablet
- save your progress and continue at a later time
- print the completed form to sign and return.

You may still print this form and complete it by hand if you prefer.

This form has been design to be completed using the free Adobe Acrobat Reader software. To download this free software, [please visit the following link](#) or search for the free “Adobe Acrobat Reader” on your device's app store.

**This form may not function as intended if you use any other software.**

## Who should complete this form?

If the applicant is a **body corporate**:

- **ONLY** the body corporate completes [PART A: Declaration of associates – Body corporate](#) (page three).
- **each director** of the body corporate **must complete a separate** [PART B: Declaration of associates – Individual/s](#) (pages four and five).

*For example: ABC Pty Ltd is applying for a restaurant and café liquor licence. There are two directors, John Smith and Jane Smith.*

1. Only ABC Pty Ltd (only) completes PART A: Declaration of associates – Body corporate. **AND**
2. John Smith completes PART B: Declaration of associates – Individual/s. **AND**
3. Jane Smith completes PART B: Declaration of associates – Individual/s.

If the applicant is an **individual**:

- the individual **must complete** [PART B: Declaration of associates – Individual/s](#) (pages four and five).

*For example: John Smith is applying for a BYO permit.*

1. John Smith completes PART B: Declaration of associates – Individual/s.

If the applicant is a **partnership**:

- each partner **must complete a separate** [PART B: Declaration of associates – Individual/s](#) (pages four and five).

*For example: John Smith and Jane Smith are applying for a pre-retail liquor licence and have entered a partnership agreement.*

1. John Smith completes PART B: Declaration of associates – Individual/s. **AND**
2. Jane Smith completes PART B: Declaration of associates – Individual/s.

If the applicant is an **associated incorporation**:

- **ONLY** the associated incorporation completes [PART A: Declaration of associates – Body corporate](#) (page three).
- **each director** of the body corporate **must complete a separate** [PART B: Declaration of associates – Individual/s](#) (pages four and five).

*For example: ABC Inc is applying for a Full Club liquor licence. There are 4 Executive Committee members, John Smith, Jane Smith, Tony Smith and Carl Smith.*

1. Only ABC Inc completes PART A: Declaration of associates – Body Corporate. **AND**
2. John Smith completes separate PART B: Declaration of associates – Individual/s. **AND**
3. Jane Smith completes separate PART B: Declaration of associates – Individual/s. **AND**
4. Tony Smith completes separate PART B: Declaration of associates – Individual/s. **AND**
5. Carl Smith completes separate PART B: Declaration of associates – Individual/s.

## Definitions – Associate

Before completing this declaration, please ensure that you read and understand the explanation of what is meant by “associate”.

Section 3AC of the *Liquor Control Reform Act 1998* (“the Act”) defines

1. an associate of a person (the “first person”) as—
  - b). a person who—
    - i. holds or will hold any relevant financial interest, or is or will be entitled to exercise any relevant power (whether in right of the person or on behalf of any other person) in any business of the first person involving the sale of liquor; and
    - ii. by virtue of that interest or power, is able or will be able to exercise a significant influence over or with respect to the management or operation of that business, or
  - c). a person who is or will be a director, whether in right of the person or on behalf of another person, of any business of the first person involving the sale of liquor; or
  - d). if the first person is a natural person, a person who is a relative of the first person, other than a relative
    - i. who is not, and has never been, involved in any business of the first person involving the sale of liquor; or
    - ii. who will not be involved in the business the first person proposes to conduct as a licensee or permittee.
2. In this section—

“**relative**”, in relation to a person, means—

  - a). the spouse or domestic partner of the person, or
  - b). a parent, son, daughter, brother or sister of the person; or
  - c). a parent, son, daughter, brother or sister of the spouse or domestic partner of the person;

“**relevant financial interest**”, in relation to a business involving the sale of liquor, means—

  - a). any share in the capital of the business; or
  - b). any entitlement to receive any payment as a result of money advanced;

“**relevant power**” means any power, whether exercisable by voting or otherwise and whether exercisable alone or in association with others—

  - a). to participate in any directorial, managerial or executive decision; or
  - b). to elect or appoint any person as a director.

**Please note:** Further to the above, a person who is or will be able to exercise a significant influence includes a shareholder owning 10 per cent or more of the shares of any business of the first person involving the sale of liquor.

## Definitions – Body Corporate

A body corporate is an organisation which has a separate legal status to its members (i.e. it can own property, sue and be sued, and enter into contracts in its own name).

Examples of body corporates include companies, incorporated associations, incorporated partnerships, municipal councils and co-operatives.

Unincorporated clubs/associations and unincorporated partnerships are not body corporates.

The director of a body corporate includes:

- any person occupying or acting in the position of director of the body corporate, by whatever name called (including partner, office holder, chief executive officer, executive committee member) and whether or not validly appointed to occupy or duly authorised to act in the position; and
- any person in accordance with whose directions or instructions the directors of the body corporate are instructed to act.

**Please note:** Directors of a Council, university or TAFE institute are not required to complete a declaration.

## Who should be declared as an associate?

Examples of persons who may be captured as associates include, but are not limited to, the following:

- each director, public officer, secretary, chief executive, chief financial officer, committee member of a body corporate
- shareholders who are able to exercise a significant influence over or with respect to the management or operation of any business of the applicant/director of the body corporate involving the sale of liquor
- where the applicant is a trustee of a trust, associates may include trust unit holders or beneficiaries who, by virtue of the Trust Deed, have voting rights enabling them to remove or change the trustee, or to influence decisions of the trustee.



## PART A: Declaration of associates – Body corporate, including companies and incorporated associations to complete

**NOTE:** Individuals, partnerships and directors of a body corporate are not required to complete this part. Please proceed to [Part B](#).

### 1: Name of body corporate making declaration

### 2: Businesses involving the sale of liquor

Provide details of all businesses that the body corporate has that involve the sale of liquor (including the business which is the subject of this declaration).

Business name/ Company name	Type of business	Registered address	ACN/ABN

### 3: Declaration of associates – Relevant financial interest/relevant power and significant influence or director

For each business listed above in question two, provide details of all individuals who are associates. This includes:

- directors (either in their own right or on behalf of another person) of the business
- individuals that hold a relevant financial interest in the business AND is/will be able to exercise a significant influence over the management or operation of the business
- individuals that will be entitled to exercise any relevant power in the business (either in their own right or on behalf of another person) AND is/will be able to exercise a significant influence over the management or operation of the business.

Name of individual	Residential address	Date of birth (dd/mm/yyyy)	Business name/ (as listed in Part 2)	Tick if also a director of this business

### 4: No associates to declare (if applicable)

I have read the definition of associates and confirm that the body corporate has no associates as defined in the *Liquor Control Reform Act 1998*.

### Signature/declaration of person/body corporate who is making this declaration

I declare that:

- the information contained in this form is true and correct
- if a body corporate is making this declaration by declaring its associates, I am authorised to sign this application on behalf of the body corporate.

Name:

Position (if body corporate):

Signature:

Date (dd/mm/yyyy):

## PART B: Declaration of associates – Individual/s to complete

NOTE: Directors of the body corporate in PART A, applications in an individual's name and all members of a partnership need to complete this form. Please refer to the ['Who should complete this form'](#) section on page one.

### 1: Name of individual completing this declaration

### 2: Relationship to applicant (for example director of body corporate)

### 3: Businesses involving the sale of liquor

Provide details of all businesses that you have an interest in, that involve the sale of liquor (including the business which is the subject of this declaration).

Business name/ Company Name	Type of business	Registered Address	ACN/ABN

### 4: Declaration of associates - Relevant financial interest/relevant power and significant influence or director

If you are part of a body corporate completing this form, the directors that are part of that body corporate do not need to be listed below. For every business you are involved in listed above in question three, provide details of all individuals who are associated with those businesses. This includes:

- directors (either in their own right or on behalf of another person) of the business
- individuals that hold a relevant financial interest in the business AND is/will be able to exercise a significant influence over the management or operation of the business
- individuals that will be entitled to exercise any relevant power in the business (either in their own right or on behalf of another person) AND is or will be able to exercise a significant influence over the management or operation of the business.

Name of individual	Residential address	Date of birth (dd/mm/yyyy)	Business name/ (as listed in Part 3)	Tick if also a director of this business

### 5: Declaration of associates - Relatives

Please refer to the definition on page one of this form prior to completing this section.

Name	Residential address	Date of birth (dd/mm/yyyy)

## 6: No associates to declare (if applicable)

I have read the definition of associates and confirm that I have no associates as defined in the *Liquor Control Reform Act 1998*.

## Signature/declaration of individual who is making this declaration

I declare that the information contained in this form is true and correct

Name:

Date (dd/mm/yyyy):

Signature:

# PUBLIC NOTICE

## Liquor licence application

Details of liquor licence application lodged  
with Liquor Control Victoria (LCV)

Liquor Control Reform Act 1998

Name of applicant: (person/partnership/company/club)		
Display period:	Start date (dd/mm/yyyy):	End date (dd/mm/yyyy):
Type of application:	Application no:	
Name and address of premises to which the application relates:		
Address of previous premises if relocating:		
The purpose of the application is to:		
The proposed days and hours of trade are:		
Will these hours apply to an external area?	YES	NO
The current days and hours of trade are: (if existing licensee)		
I/we have requested authority to supply liquor at the kerbside area	YES	NO

### Objections

All objections will be treated as public documents. Full details of the objection, including the name and address of the objector will be provided to the applicant.

#### Grounds for objection

Any person may object to the grant of this application on the ground that it would detract from, or be detrimental to, the amenity of the area in which the premises are located.

#### Objection periods

All objections must state the grounds and the reasons for the objection and be made within 30 days of this notice being first displayed.

#### Additional grounds for objection to the grant relating to a packaged liquor licence

Any person may object to the grant of an application relating to a packaged liquor licence on the ground that the grant, variation or relocation would be conducive to encourage harm.

#### The following are not valid reasons for objection:

- the business would not be successful
- another licensed business would be adversely affected, or
- there is insufficient need or demand to justify the grant of the application.

#### The Commission may refuse to accept an objection if:

- the person making the objection is not affected by the application,
- the objection is frivolous or vexatious, or
- the objection is not otherwise in accordance with the *Liquor Control Reform Act 1998*.

#### Objections must be made in writing to LCV:

- online at [liquor.vic.gov.au](http://liquor.vic.gov.au)
- via email at [contact@liquor.vic.gov.au](mailto:contact@liquor.vic.gov.au)
- or via post to: Liquor Control Victoria, PO Box 1019, Richmond VIC 3121

### Display requirements

This notice must be displayed as A3 size.

This notice must be continuously displayed as A3 size on the site or premises that are the subject of the application for the period advised in writing by Liquor Control Victoria. If you are unable to print the public notices as A3 size, email [contact@liquor.vic.gov.au](mailto:contact@liquor.vic.gov.au) or telephone 1300 182 457 to request a copy.

The notice must be displayed in a manner that invites public attention to the application on the main street frontage of the site or premises in a visible position and at eye level.

#### Statement of Display requirements

Statement of Display forms cannot be lodged until the Public Notice display period has ended.

Liquor Control Victoria



## Example of Completed Notice

### Details of liquor licence application lodged with Liquor Control Victoria (LCV)

Once the application has been accepted, the applicant will be advised in writing of the start and end date that the public notice must be continuously displayed.

Insert the full name and address of the premises for which a licence is sought:

Provide details of your application. (Applications to vary the conditions of existing licences must clearly contrast your proposed conditions with your current conditions).

Indicate "yes" or "no" if the proposed trading hours apply to an external area.

On-premises licence holders may, with the consent of the local municipal authority, offer a kerbside area. Indicate "Yes" or "No" if you have requested an authority to supply liquor in such an area.

(If you are unable to print the public notices as A3 size, email [contact@liquor.vic.gov.au](mailto:contact@liquor.vic.gov.au) or telephone 1300 182 457 to request a copy)

### Details of liquor licence application lodged with Liquor Control Victoria (LCV)

Operate a restaurant, operate a bar, extend my licensed area, patron numbers to 500. Extend trading hours on Friday and Saturday to 1am.	<input checked="" type="checkbox"/> YES <input type="checkbox"/> NO
Sunday 10am to 12 Midnight Good Friday and ANZAC Day 12 noon to 12 Midnight On any other day 7am to 1am	<input checked="" type="checkbox"/> YES <input type="checkbox"/> NO
Sunday 10am to 11pm Good Friday and ANZAC Day 12 noon to 11pm On any other day 7 am to 11pm	<input checked="" type="checkbox"/> YES <input type="checkbox"/> NO

## Display requirements

**Grounds for objection**  
Any person may object to the grant of this application on the ground that it would detract from, or be detrimental to, the amenity of the area in which the premises are located.

**Objection periods**

**Additional grounds for objection to the grant relating to a packaged liquor licence**

Any person may object to the grant of an application relating to a packaged liquor licence on the ground that the grant or variation or relocation would be conducive to encourage harm.

Any person may object to the grant of an application relating to a packaged liquor licence on the ground that the grant of the licence would be conducive to encourage harm.

- the business would not be successful
- another licensed business would be adversely affected, or
- there is insufficient need or demand to justify the grant of the

- the person making the objection is not affected by the application

Objections must be made in writing to ICM.

- via email at [contact@liquor.vic.gov.au](mailto:contact@liquor.vic.gov.au)

PO Box 1019, Richmond 3121  
**P:** 1300 182 457 **E:** [contact@liquor.vic.gov.au](mailto:contact@liquor.vic.gov.au)  
[liquor.vic.gov.au](http://liquor.vic.gov.au)



# Statement of display

To be completed after the 28 day public notice period has passed

*Liquor Control Reform Act 1998*

## Details of application lodged with Liquor Control Victoria (LCV)

Licence number: (if licence has already been granted)

File number: (this can be found on correspondence sent to you by the Commission)

Name of licence applicant: (person/partnership/company/club)

ACN: (if applicable)

Address of premises:

Display period required by the Victorian Liquor Commission (the Commission):

Start date (dd/mm/yyyy):

End date:(dd/mm/yyyy):

## Signature and certification of public notice display

### Certification

I being the applicant, or on behalf of the applicant certify that:

- during the period specified in this form, a public notice of the size and in the format required by the Commission and containing all relevant details of the application was displayed on the premises or site to which the application relates; and
- the public notice was continuously and conspicuously displayed during the period advised by the Commission in accordance with the guidelines for the display of liquor licensing applications.

I understand that it is an offence under Section 118 of the *Liquor Control Reform Act 1998* to make a false or misleading statement and that penalties apply.

Signature of person making this declaration:

Printed name:

Date (dd/mm/yyyy):

Address:

Daytime telephone number:

## How to lodge this form

### By post

Liquor Control Victoria  
PO Box 1019, Richmond VIC 3121  
Phone: 1300 182 457

### By email

[contact@liquor.vic.gov.au](mailto:contact@liquor.vic.gov.au)

# Plans of licensed premises

When a liquor licence or BYO permit is granted, it is for a defined area where liquor can be supplied or consumed. This is shown by a red-line drawn on a plan of the premises. This plan needs to be submitted to Liquor Control Victoria (LCV) as part of the application process and may be required upon request at any time.

## The plan of the premises must accompany applications for:

- a licence or BYO permit excluding a pre-retail licence or a BYO permit for party bus
- a variation of a licence or BYO permit that involves a change to the size or perimeter of the licensed premises
- a transfer of a licence or BYO permit if the current floor layout of the premises differs from the plan held at LCV
- the relocation of a licence or BYO permit.

## Internal changes to premises

If a change is made to the internal area of licensed premises (for example, by adding or removing a particular structure), the licensee should submit an updated plan of the licensed premises.

## LCV requesting a plan

In addition to the above, under section 130(1)(a) of the *Liquor Control Reform Act 1998* an authorised person (such as a LCV Inspector or member of Victoria Police) may at any time request information relevant to the operations or the management of the premises. This may include a current plan of a licensed premises.

## Plan format

A plan must contain the following elements:

- be on suitably sized paper, minimum A4 size (graph paper is not acceptable)
- be drawn in ink and be neat and legible
- show the floor plan(s) of the owned or leased property
- note the size of the red-lined area in metres squared
- outline in red the boundaries of the proposed area to be licensed
- if the proposed area does not follow a physical barrier (such as a wall), describe what is being used to separate the area
- show clear and consistent measurements on the plan
- include the address of the premises
- include a compass point showing north and names of the surrounding streets
- show basic functions or fixtures, for example, bar and dining area/kitchen area or in the case of a packaged liquor outlet, shelf areas where alcohol is displayed and the cash register is located
- a plan should be drawn to a suitable scale so that all elements above are clearly identified. A suggested scale is 1:100 (1cm = 1m).



An example of a plan is provided below.

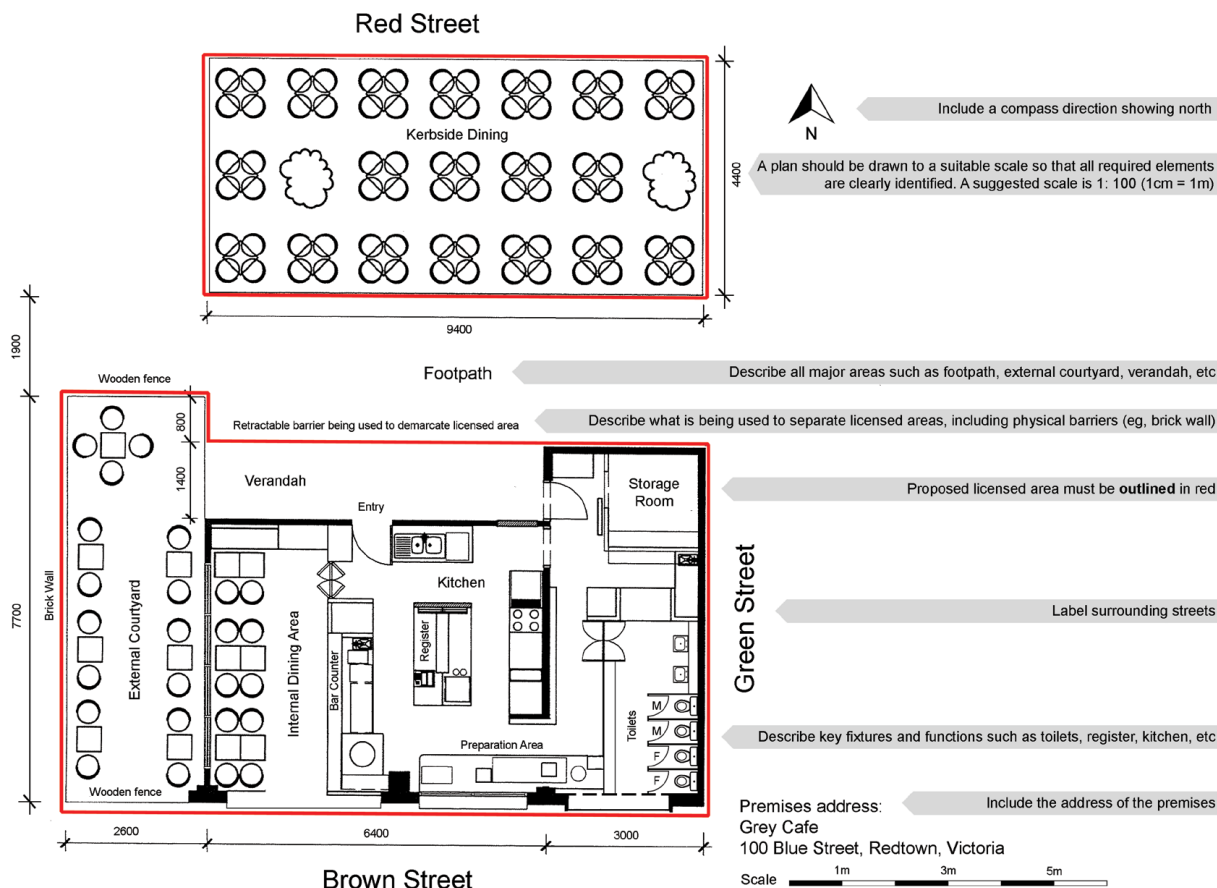

## Restaurant and cafe licences and On-premises licences

If applying for kerbside trading, identify the area to be licensed and separately outline this area in on the plan. LCV will mark this area with an A.A on the approved copy of the plan. This area is referred to as the Authorised Area.

### General licences

A general licence authorises the supply of liquor to patrons for consumption off the licensed premises, being a footpath or kerbside area. Therefore this area does not need to be identified on the plan.

Please note that licensees must comply with relevant local planning laws.

Where a proposed licensed or authorised area includes large outdoor spaces, a separate site plan must be provided that shows:

- the entire site including internal and external areas drawn to a suitable scale
- outline in red the proposed area that is to be licensed
- clear descriptions of how the proposed outdoor area will be distinguished (for example, fence, portable barriers, warning signs).

If the plan does not meet these requirements, the applicant will be required to resubmit the plan.

## Storing an approved plan

A copy of the approved plan must be kept on the licensed premises and must be available for inspection on request by a member of Victoria Police or a Compliance Inspector.

Failure to keep a copy of the plan on the licensed premises or produce a copy of the plan for inspection could result in a fine being issued.

If you do not have a copy of your approved plan, you can obtain a copy from LCV at no extra cost.

# Training for liquor licence applicants

Training for licence applicants helps potential licensees to understand their obligations under the *Liquor Control Reform Act 1998* (the Act). Applicants must complete mandatory training requirements before a liquor licence is granted. There are three courses that applicants must complete depending on the licence type they are applying for. These are:

- New entrant training
- Responsible Service of Alcohol (RSA)
- Advanced Responsible Service of Alcohol (RSA)

It is the applicant's responsibility to ensure the correct course is completed and to provide evidence of completion with their application.

## New entrant training

New entrant training is a training course developed by Liquor Control Victoria (LCV) to ensure that liquor licence applicants have an adequate knowledge of liquor law. This includes:

- liquor licensing legislation
- best practice in managing licensed premises.
- understanding liquor licence obligations

The Act provides that LCV may refuse to grant a liquor licence application if the applicant does not have an adequate understanding of the Act.

Applicants are required to complete one of the approved training courses to meet the new entrant requirements.

The approved courses and listed providers are available at [vic.gov.au/new-entrant-training-licensed-premises](https://vic.gov.au/new-entrant-training-licensed-premises)

## Licensees requiring new entrant training

Applications for the following licences require evidence that the applicant has completed new entrant training:

- general
- on-premises
- packaged liquor
- late night (general, on-premises and packaged liquor)
- restaurant and cafe
- remote seller's packaged liquor
- full club
- restricted club
- producer's
- renewable limited
- transfer of an existing licence or permit.

## Applicants who must complete the training

The list below identifies who will need to complete new entrant training. If applying as:

- individuals—all natural persons
- partnerships—all partners
- company (body corporate)—at least one director
- club—at least one committee member
- association—at least one committee member.

In addition:

- all persons being appointed as a liquor licence nominee must complete new entrant training.
- all applicants seeking approval to sublet any part of the licensed premises, or to carry on the business of supplying liquor on the licensed premises, must complete new entrant training.

## Responsible Service of Alcohol (RSA)

RSA training provides licensees and staff who work in licensed venues with the skills and knowledge necessary to contribute to a safe, enjoyable environment in licensed premises.

Training must be completed with RSA approved provider. The list of the approved providers is available at: [vic.gov.au/responsible-service-alcohol-training#approved-rsa-training-providers](https://vic.gov.au/responsible-service-alcohol-training#approved-rsa-training-providers)

If you have completed your RSA training course more than three years ago, you can complete a RSA refresher course online at [liquor.vcglr.vic.gov.au/rsa\\_refresher/](https://liquor.vcglr.vic.gov.au/rsa_refresher/)

## Licences requiring RSA training

Applications for the following licences require evidence that the applicant has completed RSA training:

- general
- on-premises
- packaged liquor
- late night (general, on-premises and packaged liquor)
- restaurant and cafe
- full club
- restricted club
- producer's
- renewable limited (only where in person sales occur)
- transfer of an existing licence or permit.

## Applicants who must complete the training

The list below identifies who will need to complete RSA training. If applying as:

- individuals—all natural persons
- partnerships—all partners
- body corporate applicants (companies, incorporated associations, co-operatives or municipal councils)—the person who is or will be in management and control of the licensed premises and who will run the day-to-day operations of the business.

Note: On the application form, body corporate applicants must advise LCV of the person's name who manages or will manage the day-to-day operations of the business.

The approved RSA training course must have been completed within the past three years.

## Exemption from RSA training

In exceptional circumstances, a liquor licence applicant may seek an exemption from one or all of the RSA training obligations.

General, on-premises, packaged liquor or late night (general, on-premises and packaged) licence applicants must complete the 'Application for the exemption from the Responsible Service of Alcohol training requirements' form available at [vic.gov.au/responsible-service-alcohol-training](https://vic.gov.au/responsible-service-alcohol-training)

All other liquor licence applicants are required to write a letter to LCV detailing the reasons for seeking an exemption before the licence is granted.

## Advanced Responsible Service of Alcohol

The Advanced RSA training is designed for licensees, managers and staff of late night venues who often face a range of challenges and issues.

For new applicants, the Advanced RSA training program must be completed within six months of the licence being granted.

William Angliss Institute delivers the Advanced RSA training program. For further information about the course and how to book, please visit the William Angliss Institute website at [shortcourses.angliss.edu.au](https://shortcourses.angliss.edu.au)

## Licences requiring Advanced RSA training

Applications for the following licences must complete Advanced RSA training:

- new late night (general) or
- late night (on-premises) that authorises the supply of liquor after 1am for on-premises consumption.

This requirement does not apply in relation to late night (on-premises) licences with restaurant and cafe conditions.

## Applicants who must complete the training

The Advanced RSA training program must be completed by the holder of the licence and by the responsible person for the premises.

The holder of the licence means, in relation to a licence held by:

- a natural person, that person
- a partnership, one partner
- a body corporate incorporated under the *Corporations Act 2001*, one director, and
- an association incorporated under the *Associations Incorporation Reform Act 2012*, one committee member.

Responsible person is defined by section 3 of the Act as the person responsible for the management or control of licensed premises.

**Evidence of approved new entrant and approved RSA training courses must be provided to LCV prior to a liquor licence being granted, transferred or endorsed. You will be required to provide this evidence with submission of your application.**

For further information about new entrant, RSA and Advanced RSA training requirements, please visit [liquor.vic.gov.au](https://liquor.vic.gov.au)